

PARTS Bulletin

URGENT: Please distribute copies for the following people within your organization:

Owner ☒ Sales ☒ Customer Service ☒ Service Techs ☒

Parts Bulletin #1 May 2016

To: All VSGA Distributors

Subject: Return line for SM4T series

Ladies and Gentlemen,

In order to solve the trouble caused by small leaking of the cylinder and to prolong the lifetime of the cylinder, we design the return line for SM4T series. SM4T series contains the lifts below: SM4T, CR4T, RSM4T and DSM4T.

For the lifts produced after 2015, the parts needed are already packaged with the lift.

For the lifts produced before 2015, if the cylinder failed, the lift will need the SM4T feedback line kit and the tank for the PU with elbow to replace the failed cylinder and install the return line for the lift. The serial number is necessary for checking which PU we use for lift and send the right tank.

SM4T feedback line kit (Long code: 52.01.02.05.SM4T FEEDBACK LINE KIT) contains the parts below:

PART NO	DISCRIPTION	QTY
YG30-9100G	cylinder	1
50.02.06.03	Hose	0.22m
50.02.06.03	Hose	2.53m
SPL8-02	Elbow	1
EPC8-02	Elbow	1
SPM-8	Elbow	1

Part number: 99, 100, 101, 102 are new added parts for the lift.

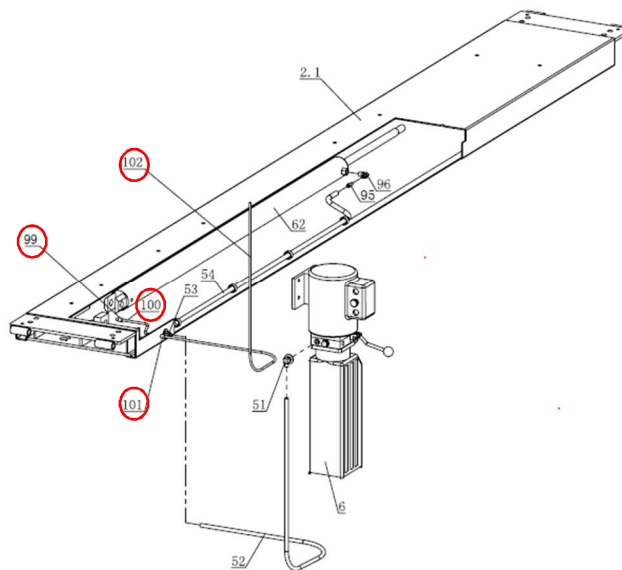

(Detail Installation information please check technical file: Installation instruction on return line of SM4T series.)

Sincerely,

Xiaowei Yin
Technical Support Engineer